

Product Catalogue



WALL PLUG SYSTEMS TECHNICAL GUIDE

The most important parameters affecting the wall plug system are;

- Basic materials - the material in which wall plug is installed
- Properties of the component to be mounted - desired properties including vibration, seismic resistance
- Temperature - maximum and minimum temperatures
- Corrosivity of the environment - Humidity of the environment and the effect of the other chemicals on the corrosion

Basic Materials



Concrete

Concrete is the most-used construction material. The connections should be made after the concrete curing.

Classification of concrete strength is denoted by universal grades like C20/25.

These grades are determined according to the compressive strength.

To calculate the compressive strength, cylindrical (16x32 cm) and cubic (15x15x15 cm) strength are tested.

Concrete class	Cylindrical strength	Cubic strength
C16/20	16 Mpa	20 Mpa
C20/25	20 Mpa	25 Mpa
C25/30	25 Mpa	30 Mpa
C30/37	30 Mpa	37 Mpa
C35/45	35 Mpa	45 Mpa
C45/55	45 Mpa	55 Mpa
C50/60	50 Mpa	60 Mpa

Cubic strength is commonly tested in Turkey. In other words, C30 in Turkey means C25/30.

Another classification of concrete is made according to the forces on the concrete. In general, the concrete is classified as uncracked if there is compression force, and the concrete is classified as cracked if there is tension force.



Solid Brick

Solid Bricks are the materials made from clay. They are one of the oldest construction materials. They are usually used for walling in reinforced concrete buildings or as an architectural facade material.

Their compressive strength is much less than that of concrete.

They are also more brittle around the edges.

For bricks, polymer (plastic) wall plugs and chemical wall plugs are generally used.



Hollow Brick

Hollow bricks are the most-used walling material. They have wide range of frontal shapes and hole shapes. Some of them are brought together under standards. Wall plugs are tested using the bricks complied with the standards.

These types of bricks have much thicker exterior wall than their interior wall.

Therefore, the most resistant wall is the most appropriate one to install the wall plug.

The wall plugs compatible with that wall are generally preferred for the applications.

It is important to know that the hollow bricks produced in Turkey and standard hollow bricks are absolutely different. As the bricks produced in Turkey are more thin-walled, light-weighted and much fragile, they are problematic for the wall plugs. Star Plastik takes those bricks produced in Turkey into consideration while improving the wall plugs.



Aerated Concrete

Not putting stress on the building with its light and hollow structure, it is a construction material which also provides sound and heat insulation.

Becoming widespread, this material is problematic for the wall plug systems.

It is not appropriate for the friction wall plugs because of its crumbly structure.

Form-locking is needed. Generally, the loads should be limited for the wall plugs to be installed in aerated concrete.

Maximum loads can be carried only with the custom-engineered systems for aerated concrete like Star Plastik.



Bims

Produced by using concrete, Bims bricks are non-persistent and brittle construction materials. They have hollow structure. Even if their walls are thick, they get thinner and cracked during the drilling process. They are very problematic construction materials for the wall plug systems.



Gypsum Board

Used for architectural purposes or creating rooms in the buildings, gypsum boards are made by transforming gypsum into board. Gypsum is a non-persistent material. As there is almost always a hollowness behind the gypsum board in the gypsum board systems, many hold-back wall plug designs have been developed.

Wallboard –
Plywood MDF

These materials are the boards produced from wooden pieces. Thickness varies. While the most resistant one is Plywood, the most non-persistent one is Wallboard. They are considered as equal to gypsum board regarding the wall plug system, if possible, hold-back wall plug is recommended.

Drilling

The drilling process is determined up to the construction material. There are four alternatives:

Non-impact drilling: Rotary drilling without any impact, preferred in hollow bricks and non-persistent construction materials. To prevent the hole from being large and to protect the inside of hollow bricks against being broken.

Impact drilling: Multiple and rotary drilling with impact drill. Preferred in dense-textured solid construction materials.

Drilling with Rotary hammer drill: Rotary drilling with less impact having high impact energy by the rotary hammer drill, similarly in dense-textured solid construction materials.

Diamond drilling: This technic is generally used for large drilling diameter. An additional recommend for the non-impact drilling: If the hard metal drill bits are sharp-grinded like steel drill bits, they drill faster. They also have special bits for brick drilling.

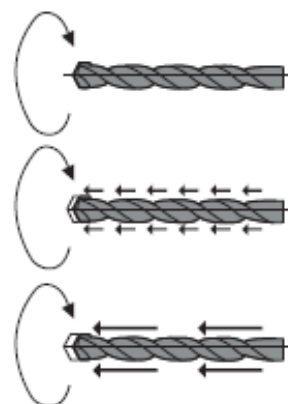

Installation

During the installation, attention should be paid to those below.

If the wall plug is to carry a required load, the thickness and wideness of the construction material should be complied as well as the edge and axis distance. Otherwise, the construction material may be broken or crack formations may occur.

Required edge distance for the plastic wall plugs is $2x_{hv}$ (x_{hv} =anchoring depth) and an axis distance is $4x_{hv}$, favourably. If the wall plug is opened parallel to the construction unit, the edge distance may be reduced to $1x_{hv}$.

Open hole depth, with a few exceptions, should be bigger than the anchoring depth: This is because screw has the sufficient area and passes over the plastic wall plug, and therefore ensures functional safety. The following pages include product tables with the hole depths of all the products.

Cleaning the hole by blowing or vacuuming air is required after the drilling process. If it is not done, unclean hole reduces the load capacity! Drill dusts affect the estimated holding of the wall plug inside the hole negatively.



SPECO WIDE CAPPED WALL PLUG

Product Code: SP-GECO-0

- It is an insulation panel connector.
- Used to fix the pressure resistant insulation materials for exterior masonry
- Can be used in all wall forms
- Its tearing design makes the application easy
- It has high holding resistance
- Provides high resistance to adze impact
- The product design was developed by STAR PLASTİK A.Ş.

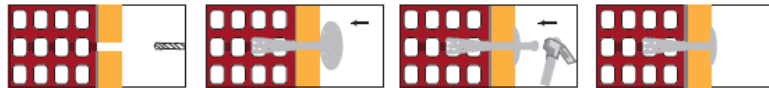

Drill Diameter

On hollow surfaces

10 mm

On solid surfaces

11 mm



Product Code	Colour	Wall Plug Cap Diameter (mm)	Wall Plug Body Diameter (mm)	Wall Plug Length (mm)	Nail Type	In-Package Quantity
SP-GECO-01-06-01	Black	60	10	60	Plastic	500
SP-GECO-01-06-02	White	60	10	60	Plastic	500
SP-GECO-01-06-03	Navy Blue	60	10	60	Plastic	500
SP-GECO-01-08-01	Black	60	10	80	Plastic	500
SP-GECO-01-08-02	White	60	10	80	Plastic	500
SP-GECO-01-08-03	Navy Blue	60	10	80	Plastic	500
SP-GECO-01-10-01	Black	60	10	100	Plastic	500
SP-GECO-01-10-02	White	60	10	100	Plastic	500
SP-GECO-01-10-03	Navy Blue	60	10	100	Plastic	500
SP-GECO-01-12-01	Black	60	10	120	Plastic	500
SP-GECO-01-12-02	White	60	10	120	Plastic	500
SP-GECO-01-12-03	Navy Blue	60	10	120	Plastic	500
SP-GECO-01-14-01	Black	60	10	140	Plastic	500
SP-GECO-01-14-02	White	60	10	140	Plastic	500
SP-GECO-01-14-03	Navy Blue	60	10	140	Plastic	500
SP-GECO-01-16-01	Black	60	10	160	Plastic	500
SP-GECO-01-16-02	White	60	10	160	Plastic	500
SP-GECO-01-16-03	Navy Blue	60	10	160	Plastic	500
SP-GECO-01-18-01	Black	60	10	180	Plastic	500
SP-GECO-01-18-02	White	60	10	180	Plastic	500
SP-GECO-01-18-03	Navy Blue	60	10	180	Plastic	500
SP-GECO-01-20-01	Black	60	10	200	Plastic	500
SP-GECO-01-20-02	White	60	10	200	Plastic	500
SP-GECO-01-20-03	Navy Blue	60	10	200	Plastic	500

PLASTIC NAIL WALL PLUG

Basic Material

- Solid Brick
- Hollow Brick
- Bims
- Aerated Concrete

Application Surface

- In Polystyrene (Eps - Xps) Applications during External Heat Insulation Panel Installation



SPECO NARROW CAPPED WALL PLUG

Product Code: SP-DECO-01

- It is an insulation panel connector
- Used to fix the pressure resistant insulation materials for exterior masonry
- Can be used in all wall forms
- Its tearing design makes the application easy
- It has high holding resistance
- The product design was developed by STAR PLASTİK A.Ş.

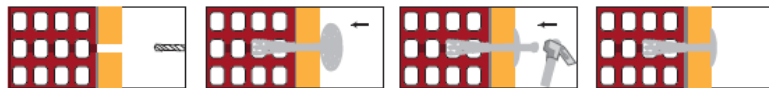

Drill Diameter

On hollow surfaces
10 mm

On solid surfaces
11 mm



Product Code	Colour	Wall Plug Cap Diameter (mm)	Wall Plug Body Diameter (mm)	Wall Plug Length (mm)	Nail Type	In-Package Quantity
SP-DECO-01-08-01	Black	50	10	80	Plastic	500
SP-DECO-01-08-02	White	50	10	80	Plastic	500
SP-DECO-01-08-03	Navy Blue	50	10	80	Plastic	500
SP-DECO-01-10-01	Black	50	10	100	Plastic	500
SP-DECO-01-10-02	White	50	10	100	Plastic	500
SP-DECO-01-10-03	Navy Blue	50	10	100	Plastic	500

PLASTIC NAIL
WALL PLUG

Basic Material

- Concrete
- Solid Brick
- Hollow Brick
- Bims
- Aerated Concrete

Application Surface

- In Polystyrene (Eps - Xps) Applications during External Heat Insulation Panel Installation

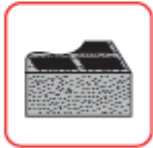

STAR WIDE CAPPED WALL PLUG

Product Code: SP-GSTR-01

- TSE K412 Certified
- It is made of first quality raw material
- It provides a reliable application for many years
- Provides high holding resistance
- It is an insulation panel connector
- Used to fix the pressure resistant insulation materials for exterior masonry
- Can be used in all wall forms
- Its tearing design makes the application easy
- The product design was developed by STAR PLASTİK A.Ş.

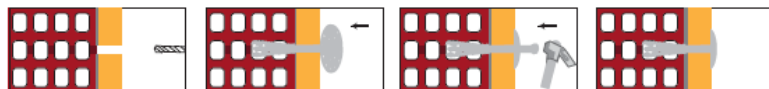

Drill Diameter

On hollow surfaces
10 mm

On solid surfaces
11 mm



Product Code	Colour	Wall Plug Cap Diameter (mm)	Wall Plug Body Diameter (mm)	Wall Plug Length (mm)	Nail Type	In-Package Quantity
SP-GSTR-01-06-01	Blue	60	10	60	Plastic	500
SP-GSTR-01-06-02	Transparent	60	10	60	Plastic	500
SP-GSTR-01-06-03	Yellow	60	10	60	Plastic	500
SP-GSTR-01-06-04	Orange	60	10	60	Plastic	500
SP-GSTR-01-06-05	Green	60	10	60	Plastic	500
SP-GSTR-01-06-06	Red	60	10	60	Plastic	500
SP-GSTR-01-08-01	Blue	60	10	80	Plastic	500
SP-GSTR-01-08-02	Transparent	60	10	80	Plastic	500
SP-GSTR-01-08-03	Yellow	60	10	80	Plastic	500
SP-GSTR-01-08-04	Orange	60	10	80	Plastic	500
SP-GSTR-01-08-05	Green	60	10	80	Plastic	500
SP-GSTR-01-08-06	Red	60	10	80	Plastic	500
SP-GSTR-01-10-01	Blue	60	10	100	Plastic	500
SP-GSTR-01-10-02	Transparent	60	10	100	Plastic	500
SP-GSTR-01-10-03	Yellow	60	10	100	Plastic	500
SP-GSTR-01-10-04	Orange	60	10	100	Plastic	500
SP-GSTR-01-10-05	Green	60	10	100	Plastic	500
SP-GSTR-01-10-06	Red	60	10	100	Plastic	500
SP-GSTR-01-12-01	Blue	60	10	120	Plastic	500
SP-GSTR-01-12-02	Transparent	60	10	120	Plastic	500
SP-GSTR-01-12-03	Yellow	60	10	120	Plastic	500
SP-GSTR-01-12-04	Orange	60	10	120	Plastic	500
SP-GSTR-01-12-05	Green	60	10	120	Plastic	500
SP-GSTR-01-12-06	Red	60	10	120	Plastic	500
SP-GSTR-01-14-01	Blue	60	10	140	Plastic	500
SP-GSTR-01-14-02	Transparent	60	10	140	Plastic	500
SP-GSTR-01-14-03	Yellow	60	10	140	Plastic	500
SP-GSTR-01-14-04	Orange	60	10	140	Plastic	500
SP-GSTR-01-14-05	Green	60	10	140	Plastic	500
SP-GSTR-01-14-06	Red	60	10	140	Plastic	500
SP-GSTR-01-16-01	Blue	60	10	160	Plastic	500
SP-GSTR-01-16-02	Transparent	60	10	160	Plastic	500
SP-GSTR-01-16-03	Yellow	60	10	160	Plastic	500
SP-GSTR-01-16-04	Orange	60	10	160	Plastic	500
SP-GSTR-01-16-05	Green	60	10	160	Plastic	500
SP-GSTR-01-16-06	Red	60	10	160	Plastic	500
SP-GSTR-01-18-01	Blue	60	10	180	Plastic	500
SP-GSTR-01-18-02	Transparent	60	10	180	Plastic	500
SP-GSTR-01-18-03	Yellow	60	10	180	Plastic	500
SP-GSTR-01-18-04	Orange	60	10	180	Plastic	500
SP-GSTR-01-18-05	Green	60	10	180	Plastic	500
SP-GSTR-01-18-06	Red	60	10	180	Plastic	500
SP-GSTR-01-20-01	Blue	60	10	200	Plastic	500
SP-GSTR-01-20-02	Transparent	60	10	200	Plastic	500
SP-GSTR-01-20-03	Yellow	60	10	200	Plastic	500
SP-GSTR-01-20-04	Orange	60	10	200	Plastic	500
SP-GSTR-01-20-05	Green	60	10	200	Plastic	500
SP-GSTR-01-20-06	Red	60	10	200	Plastic	500

PLASTIC NAIL WALL PLUG

Basic Material

- Concrete
- Solid Brick
- Hollow Brick
- Bims
- Aerated Concrete

Application Surface

- In Polystyrene (Eps - Xps) Applications during External Heat Insulation Panel Installation



STAR WIDE CAPPED WALL PLUG (NEW DESIGN)

Product Code: SP-DSTR-01

- TSE K412 Certified
- Excellent design
- High peel resistance
- Easy-to-install
- It is made of first quality raw material
- It provides a reliable application for many years
- Safe load distribution
- The details on its head increase plaster retention
- Shows high holding resistance thanks to its tearing design
- It is an insulation panel connector
- Used to fix the pressure resistant insulation materials for exterior masonry
- Can be used in all wall forms
- Provides high resistance to adze impact
- The product design was developed by STAR PLASTİK A.Ş.

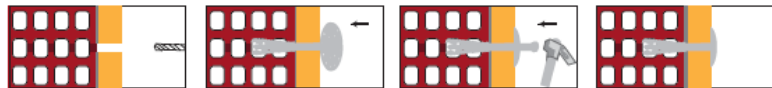

Drill Diameter

On hollow surfaces

10 mm

On solid surfaces

11 mm



Product Code	Colour	Wall Plug Cap Diameter (mm)	Wall Plug Body Diameter (mm)	Wall Plug Length (mm)	Nail Type	In-Package Quantity
SP-GSTR-01-10-01	Blue	60	10	100	Plastic	500
SP-GSTR-01-10-02	Transparent	60	10	100	Plastic	500
SP-GSTR-01-10-03	Yellow	60	10	100	Plastic	500
SP-GSTR-01-10-04	Orange	60	10	100	Plastic	500
SP-GSTR-01-10-05	Green	60	10	100	Plastic	500
SP-GSTR-01-10-06	Red	60	10	100	Plastic	500
SP-GSTR-01-12-01	Blue	60	10	120	Plastic	500
SP-GSTR-01-12-02	Transparent	60	10	120	Plastic	500
SP-GSTR-01-12-03	Yellow	60	10	120	Plastic	500
SP-GSTR-01-12-04	Orange	60	10	120	Plastic	500
SP-GSTR-01-12-05	Green	60	10	120	Plastic	500
SP-GSTR-01-12-06	Red	60	10	120	Plastic	500
SP-GSTR-01-14-01	Blue	60	10	140	Plastic	500
SP-GSTR-01-14-02	Transparent	60	10	140	Plastic	500
SP-GSTR-01-14-03	Yellow	60	10	140	Plastic	500
SP-GSTR-01-14-04	Orange	60	10	140	Plastic	500
SP-GSTR-01-14-05	Green	60	10	140	Plastic	500
SP-GSTR-01-14-06	Red	60	10	140	Plastic	500
SP-GSTR-01-16-01	Blue	60	10	160	Plastic	500
SP-GSTR-01-16-02	Transparent	60	10	160	Plastic	500
SP-GSTR-01-16-03	Yellow	60	10	160	Plastic	500
SP-GSTR-01-16-04	Orange	60	10	160	Plastic	500
SP-GSTR-01-16-05	Green	60	10	160	Plastic	500
SP-GSTR-01-16-06	Red	60	10	160	Plastic	500
SP-GSTR-01-18-01	Blue	60	10	180	Plastic	500
SP-GSTR-01-18-02	Transparent	60	10	180	Plastic	500
SP-GSTR-01-18-03	Yellow	60	10	180	Plastic	500
SP-GSTR-01-18-04	Orange	60	10	180	Plastic	500
SP-GSTR-01-18-05	Green	60	10	180	Plastic	500
SP-GSTR-01-18-06	Red	60	10	180	Plastic	500
SP-GSTR-01-20-01	Blue	60	10	200	Plastic	500
SP-GSTR-01-20-02	Transparent	60	10	200	Plastic	500
SP-GSTR-01-20-03	Yellow	60	10	200	Plastic	500
SP-GSTR-01-20-04	Orange	60	10	200	Plastic	500
SP-GSTR-01-20-05	Green	60	10	200	Plastic	500
SP-GSTR-01-20-06	Red	60	10	200	Plastic	500

PLASTIC NAIL WALL PLUG

Basic Material

- Concrete
- Solid Brick
- Hollow Brick
- Bims
- Aerated Concrete

Application Surface

- In Polystyrene (Eps - Xps) Applications during External Heat Insulation Panel Installation



STAR NARROW CAPPED WALL PLUG

Product Code: SP-DSTR-01

- It is made of first quality raw material
- It provides a reliable application for many years
- Provides high holding resistance
- It is an insulation panel connector
- Used to fix the pressure resistant insulation materials for exterior masonry
- Can be used in all wall forms
- Its tearing design makes the application easy
- The product design was developed by STAR PLASTİK A.Ş.

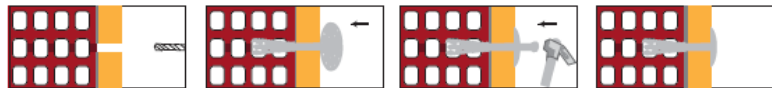

Drill Diameter

On hollow surfaces
10 mm
On solid surfaces
11 mm



Product Code	Colour	Wall Plug Cap Diameter (mm)	Wall Plug Body Diameter (mm)	Wall Plug Length (mm)	Nail Type	In-Package Quantity
SP-DSTR-01-08-01	Blue	50	10	80	Plastic	500
SP-DSTR-01-08-02	Transparent	50	10	80	Plastic	500
SP-DSTR-01-08-03	Yellow	50	10	80	Plastic	500
SP-DSTR-01-08-04	Red	50	10	80	Plastic	500
SP-DSTR-01-10-01	Blue	50	10	100	Plastic	500
SP-DSTR-01-10-02	Transparent	50	10	100	Plastic	500
SP-DSTR-01-10-03	Yellow	50	10	100	Plastic	500
SP-DSTR-01-10-04	Red	50	10	100	Plastic	500

PLASTIC NAIL WALL PLUG

Basic Material

- Concrete
- Solid Brick
- Hollow Brick
- Bims
- Aerated Concrete

Application Surface

- In Polystyrene (Eps - Xps) Applications during External Heat Insulation Panel Installation



EURO ROCK WOOL WALL PLUG

Product Code: SP-ETYD-01

- ETA 14/0197 certified
- It is an insulation panel connector
- It has 50% wider cap diameter
- Increases holding safety by applying pressure to wider area on the application surface
- It provides easy installation
- Safe load distribution
- The product design was developed by STAR PLASTİK A.Ş.
- It has a sturdy head design, which is resistant to adze impact
- Nail head prevents heat bridge formation and marking on the plaster surface

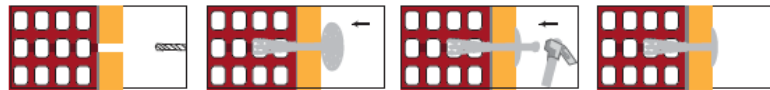

Drill Diameter

On hollow surfaces
8 mm

On solid surfaces
9 mm



Product Code	Colour	Wall Plug Cap Diameter (mm)	Wall Plug Body Diameter (mm)	Wall Plug Length (mm)	Nail Type	In-Package Quantity
SP-ETYD-01-12-01	Orange	90	8	115	Steel	500
SP-ETYD-01-14-01	Orange	90	8	135	Steel	500
SP-ETYD-01-16-01	Orange	90	8	155	Steel	500

STEEL NAIL WALL PLUG

NYLON (PA6)

Product Code	Colour	Wall Plug Cap Diameter (mm)	Wall Plug Body Diameter (mm)	Wall Plug Length (mm)	Nail Type	In-Package Quantity
SP-ETYD-02-12-01	Transparent	90	8	115	Steel	500
SP-ETYD-02-14-01	Transparent	90	8	135	Steel	500
SP-ETYD-02-16-01	Transparent	90	8	155	Steel	500

STEEL NAIL WALL PLUG

Basic Material

- Concrete
- Solid Brick
- Hollow Brick
- Bims
- Aerated Concrete

Application Surface

- Rock Wool
- Glass Wool



EURO MECHANICAL TOOTHED STEEL NAIL WALL PLUG

Product Code: SP-EPMT-01

- ETA 14/0197 certified
- It is an insulation panel connector
- Thanks to its special notched design, it is suitable for all wall surfaces
- Safe load distribution
- The details on its head increase plaster retention
- The product design was developed by STAR PLASTİK A.Ş.
- It has a sturdy head design, which is resistant to adze impact

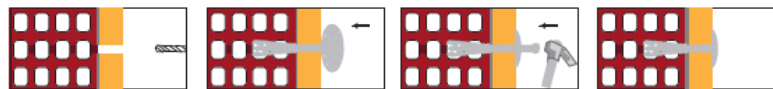

Drill Diameter

On hollow surfaces
8 mm

On solid surfaces
9 mm



Product Code	Colour	Wall Plug Cap Diameter (mm)	Wall Plug Body Diameter (mm)	Wall Plug Length (mm)	Nail Type	In-Package Quantity
SP-ECMT-01-10-01	Red	60	8	95	Steel	500
SP-ECMT-01-12-01	Red	60	8	115	Steel	500
SP-ECMT-01-14-01	Red	60	8	135	Steel	500
SP-ECMT-01-16-01	Red	60	8	155	Steel	500
SP-ECMT-01-18-01	Red	60	8	175	Steel	500
SP-ECMT-01-20-01	Red	60	8	195	Steel	500

STEEL NAIL WALL PLUG

NYLON (PA6)

Product Code	Colour	Wall Plug Cap Diameter (mm)	Wall Plug Body Diameter (mm)	Wall Plug Length (mm)	Nail Type	In-Package Quantity
SP-ECMT-02-10-01	Transparent	60	8	95	Steel	500
SP-ECMT-02-12-01	Transparent	60	8	115	Steel	500
SP-ECMT-02-14-01	Transparent	60	8	135	Steel	500
SP-ECMT-02-16-01	Transparent	60	8	155	Steel	500
SP-ECMT-02-18-01	Transparent	60	8	175	Steel	500
SP-ECMT-02-20-01	Transparent	60	8	195	Steel	500

STEEL NAIL WALL PLUG

Basic Material

- Concrete
- Solid Brick
- Hollow Brick
- Bims
- Aerated Concrete

Application Surface

- Rock Wool
- Glass Wool
- EPS Panel
- XPS Panel
- Aerated Concrete Panel

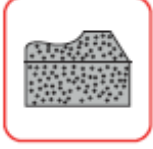

EURO STEEL NAIL CONCRETE WALL PLUG

Product Code: SP-EPCD-01

- ETA 14/0197 certified
- It is an insulation panel connector
- Thanks to its special notched design, it is suitable for all wall surfaces
- Safe load distribution
- The details on its head increase plaster retention
- The product design was developed by STAR PLASTİK A.Ş.
- It has a sturdy head design, which is resistant to adze impact
- Nail head prevents heat bridge formation and marking on the plaster surface

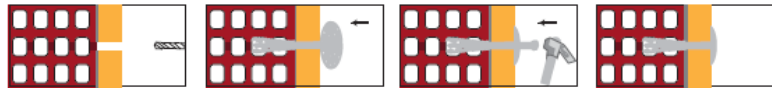

Drill Diameter
Gross concrete
8 mm



Product Code	Colour	Wall Plug Cap Diameter (mm)	Wall Plug Body Diameter (mm)	Wall Plug Length (mm)	Nail Type	In-Package Quantity
SP-ECCD-01-06-01	Red	60	8	60	Steel	500
SP-ECCD-01-08-01	Red	60	8	80	Steel	500
SP-ECCD-01-10-01	Red	60	8	95	Steel	500
SP-ECCD-01-12-01	Red	60	8	115	Steel	500
SP-ECCD-01-14-01	Red	60	8	135	Steel	500
SP-ECCD-01-16-01	Red	60	8	155	Steel	500

STEEL NAIL WALL PLUG

NYLON (PA6)

Product Code	Colour	Wall Plug Cap Diameter (mm)	Wall Plug Body Diameter (mm)	Wall Plug Length (mm)	Nail Type	In-Package Quantity
SP-ECCD-02-06-01	Transparent	60	8	60	Steel	500
SP-ECCD-02-08-01	Transparent	60	8	80	Steel	500
SP-ECCD-02-10-01	Transparent	60	8	95	Steel	500
SP-ECCD-02-12-01	Transparent	60	8	115	Steel	500
SP-ECCD-02-14-01	Transparent	60	8	135	Steel	500
SP-ECCD-02-16-01	Transparent	60	8	155	Steel	500

STEEL NAIL WALL PLUG

Basic Material

- Concrete

Application Surface

- Rock Wool
- Glass Wool
- EPS Panel
- XPS Panel
- Aerated Concrete Panel



STAR AERATED CONCRETE WALL PLUG STEEL NAIL

Product Code: SP-GZBC-01

- ETA 14/0197 certified
- It is an insulation panel connector
- Special design with 10 notches
- Shows high holding resistance on aerated concrete surfaces thanks to its special tearing design
- Safe load distribution
- The details on its head increase plaster retention
- It provides easy installation
- The product design was developed by STAR PLASTİK A.Ş.
- It has a sturdy head design, which is resistant to adze impact
- Nail head prevents heat bridge formation and marking on the plaster surface

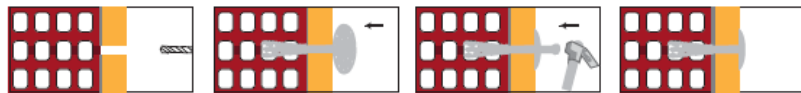

Drill Diameter

On hollow surfaces
8 mm

On solid surfaces
8 mm



Product Code	Colour	Wall Plug Cap Diameter (mm)	Wall Plug Body Diameter (mm)	Wall Plug Length (mm)	Nail Type	In-Package Quantity
SP-GZBC-01-14-01	Red	60	8	140	Steel	500
SP-GZBC-01-16-01	Red	60	8	160	Steel	500

STEEL NAIL WALL PLUG

Basic Material

- Aerated Concrete
- Hollow Brick
- Bims

Application Surface

- Rock Wool
- Glass Wool
- EPS Panel
- XPS Panel
- Aerated Concrete Panel



EURO MECHANICAL TOOTHED PLASTIC NAIL WALL PLUG

Product Code: SP-EPMT-01

- ETA 14/0197 certified
- It is an insulation panel connector
- Thanks to its special notched design, it is suitable for all wall surfaces
- Safe load distribution
- The details on its head increase plaster retention
- Plastic nail reinforced with fibreglass provides easy installation, also reduces heat transfer and prevents markings on the plaster surface
- It has a sturdy head design, which is resistant to adze impact
- The product design was developed by STAR PLASTİK A.Ş.

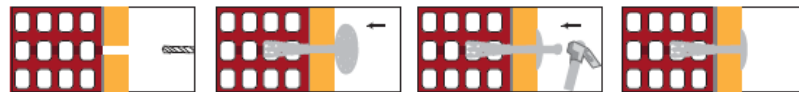

Drill Diameter

On hollow surfaces
8 mm

On solid surfaces
9 mm



Product Code	Colour	Wall Plug Cap Diameter (mm)	Wall Plug Body Diameter (mm)	Wall Plug Length (mm)	Nail Type	In-Package Quantity
SP-EPMT-01-10-01	Red	60	8	95	Plastic	500
SP-EPMT-01-12-01	Red	60	8	115	Plastic	500
SP-EPMT-01-14-01	Red	60	8	135	Plastic	500
SP-EPMT-01-16-01	Red	60	8	155	Plastic	500

PLASTIC NAIL WALL PLUG

NYLON (PA6)

Product Code	Colour	Wall Plug Cap Diameter (mm)	Wall Plug Body Diameter (mm)	Wall Plug Length (mm)	Nail Type	In-Package Quantity
SP-EPMT-02-10-01	Transparent	60	8	95	Plastic	500
SP-EPMT-02-12-01	Transparent	60	8	115	Plastic	500
SP-EPMT-02-14-01	Transparent	60	8	135	Plastic	500
SP-EPMT-02-16-01	Transparent	60	8	155	Plastic	500

PLASTIC NAIL WALL PLUG

Basic Material

- Concrete
- Solid Brick
- Hollow Brick
- Bims
- Aerated Concrete

Application Surface

- Rock Wool
- Glass Wool
- EPS Panel
- XPS Panel
- Aerated Concrete Panel



EURO PLASTIC NAIL CONCRETE WALL PLUG

Product Code: SP-EPCD-01

- ETA 14/0197 certified
- It is an insulation panel connector
- Provides fast and easy installation in exposed concrete applications, thanks to its special design
- Safe load distribution
- The details on its head increase plaster retention
- The product design was developed by STAR PLASTİK A.Ş.
- It has a sturdy head design, which is resistant to adze impact
- Plastic nail reinforced with fibreglass provides easy installation, also reduces heat transfer and prevents markings on the plaster surface

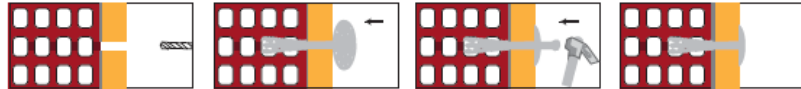

Drill Diameter
Gross concrete
8 mm



Product Code	Colour	Wall Plug Cap Diameter (mm)	Wall Plug Body Diameter (mm)	Wall Plug Length (mm)	Nail Type	In-Package Quantity
SP-EPMT-01-10-01	Red	60	8	95	Plastic	500
SP-EPMT-01-12-01	Red	60	8	115	Plastic	500
SP-EPMT-01-14-01	Red	60	8	135	Plastic	500
SP-EPMT-01-16-01	Red	60	8	155	Plastic	500

PLASTIC NAIL WALL PLUG

NYLON (PA6)

Product Code	Colour	Wall Plug Cap Diameter (mm)	Wall Plug Body Diameter (mm)	Wall Plug Length (mm)	Nail Type	In-Package Quantity
SP-EPMT-02-10-01	Transparent	60	8	95	Plastic	500
SP-EPMT-02-12-01	Transparent	60	8	115	Plastic	500
SP-EPMT-02-14-01	Transparent	60	8	135	Plastic	500
SP-EPMT-02-16-01	Transparent	60	8	155	Plastic	500

PLASTIC NAIL WALL PLUG

Basic Material

- Concrete

Application Surface

- Rock Wool
- Glass Wool
- EPS Panel
- XPS Panel
- Aerated Concrete Panel



STAR AERATED CONCRETE WALL PLUG PLASTIC NAIL

Product Code: SP-GZBP-01

- ETA 14/0197 certified
- It is an insulation panel connector
- Special design with 10 notches
- Shows high holding resistance on aerated concrete surfaces thanks to its special tearing design
- Safe load distribution
- The details on its head increase plaster retention
- Plastic nail reinforced with fibreglass provides easy installation, also reduces heat transfer and prevents markings on the plaster surface
- It has a sturdy head design, which is resistant to adze impact
- Plastic nail reinforced with fibreglass provides easy installation, also reduces heat transfer and prevents markings on the plaster surface
- The product design was developed by STAR PLASTİK A.Ş.

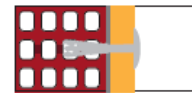
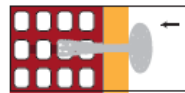
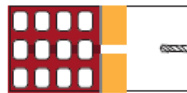

Drill Diameter

On hollow surfaces
8 mm
On solid surfaces
9 mm



Product Code	Colour	Wall Plug Cap Diameter (mm)	Wall Plug Body Diameter (mm)	Wall Plug Length (mm)	Nail Type	In-Package Quantity
SP-GZBP-01-14-01	Red	60	8	140	Plastic	500
SP-GZBP-01-16-01	Red	60	8	160	Plastic	500

PLASTIC NAIL WALL PLUG

Basic Material

- Concrete
- Hollow Brick
- Bims

Application Surface

- Rock Wool
- Glass Wool
- EPS Panel
- XPS Panel
- Aerated Concrete Panel



EURO SCREWED CONCRETE WALL PLUG

Product Code: SP-EPCD-01

- ETA 14/0197 certified
- It is an insulation panel connector
- Special design with 10 notches
- Shows high holding resistance on aerated concrete surfaces thanks to its special tearing design
- Safe load distribution
- The details on its head increase plaster retention
- It has a sturdy head design, which is resistant to adze impact



Drill Diameter
Gross concrete
8 mm



Product Code	Colour	Wall Plug Cap Diameter (mm)	Wall Plug Body Diameter (mm)	Wall Plug Length (mm)	Nail Type	In-Package Quantity
SP-EVD-01-12-01	Red	60	8	115	Screw	200
SP-EVD-01-14-01	Red	60	8	135	Screw	200
SP-EVD-01-16-01	Red	60	8	155	Screw	200
SP-EVD-01-18-01	Orange	60	8	180	Screw	200
SP-EVD-01-20-01	Orange	60	8	200	Screw	200
SP-EVD-01-22-01	Orange	60	8	220	Screw	200
SP-EVD-01-24-01	Orange	60	8	240	Screw	200
SP-EVD-01-26-01	Orange	60	8	260	Screw	200
SP-EVD-01-28-01	Orange	60	8	280	Screw	200
SP-EVD-01-30-01	Orange	60	8	300	Screw	200

SCREWED WALL PLUG

NYLON (PA6)

Product Code	Colour	Wall Plug Cap Diameter (mm)	Wall Plug Body Diameter (mm)	Wall Plug Length (mm)	Nail Type	In-Package Quantity
SP-EVD-02-12-01	Red	60	8	115	Screw	200
SP-EVD-02-14-01	Red	60	8	135	Screw	200
SP-EVD-02-16-01	Red	60	8	155	Screw	200
SP-EVD-02-18-01	Orange	60	8	180	Screw	200
SP-EVD-02-20-01	Orange	60	8	200	Screw	200
SP-EVD-02-22-01	Orange	60	8	220	Screw	200
SP-EVD-02-24-01	Orange	60	8	240	Screw	200
SP-EVD-02-26-01	Orange	60	8	260	Screw	200
SP-EVD-02-28-01	Orange	60	8	280	Screw	200
SP-EVD-02-30-01	Orange	60	8	300	Screw	200

SCREWED WALL PLUG

Basic Material

- Concrete
- Solid Brick
- Hollow Brick
- Bims
- Aerated Concrete

Application Surface

- Rock Wool
- Glass Wool
- EPS Panel
- XPS Panel
- Aerated Concrete Panel



EURO SCREWED MECHANICAL TOOTHED WALL PLUG

Product Code: SP-EVMT-01

- ETA 14/0197 certified
- It is an insulation panel connector
- Thanks to its special notched design, it is suitable for all wall surfaces
- Safe load distribution
- The details on its head increase plaster retention
- The product design was developed by STAR PLASTİK A.Ş.
- Screw of the wall plug should be installed by drill



Drill Diameter

On hollow surfaces
8 mm

On solid surfaces
9 mm



Product Code	Colour	Wall Plug Cap Diameter (mm)	Wall Plug Body Diameter (mm)	Wall Plug Length (mm)	Nail Type	In-Package Quantity
SP-EVMT-01-10-01	Red	60	8	95	Screw	500
SP-EVMT-01-12-01	Red	60	8	115	Screw	500
SP-EVMT-01-14-01	Red	60	8	135	Screw	500
SP-EVMT-01-16-01	Red	60	8	155	Screw	500
SP-EVMT-01-18-01	Red	60	8	175	Screw	500
SP-EVMT-01-20-01	Red	60	8	195	Screw	500

SCREWED WALL PLUG

Basic Material

- Concrete
- Solid Brick
- Hollow Brick
- Bims
- Aerated Concrete

Application Surface

- Rock Wool
- Glass Wool
- Aerated Concrete Panel



WIDE CAPPED UNIVERSAL WALL PLUG

Product Code: SP-GUNI-01

- TSE K412 Certified
- It is an insulation panel connector
- Designed with a special angle to provide holding for each insulation thickness
- Thanks to the wings on its body opening at maximum level during the nail mounting, it provides high holding resistance
- It has a sturdy head design, which is resistant to adze impact
- Used to fix the pressure resistant insulation materials for exterior materials
- Can be used in all wall forms
- The product design was developed by STAR PLASTİK A.Ş.

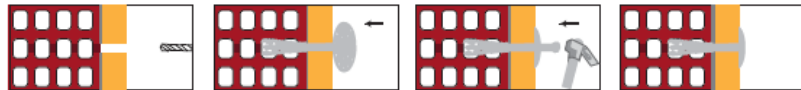

Drill Diameter

On hollow surfaces
10 mm
On solid surfaces
11 mm



Product Code	Colour	Wall Plug Cap Diameter (mm)	Wall Plug Body Diameter (mm)	Wall Plug Length (mm)	Nail Type	In-Package Quantity
SP-GUNI-01-10-01	Colourful	60	10	100	Plastic	500
SP-GUNI-01-12-01	Colourful	60	10	120	Plastic	500
SP-GUNI-01-14-01	Colourful	60	10	140	Plastic	500

PLASTIC NAIL WALL PLUG

Basic Material

- Bims
- Hollow Brick
- Aerated Concrete

Application Surface

- Rock Wool
- Glass Wool
- EPS Panel
- XPS Panel



HIGH ADHERENCE AERATED CONCRETE WALL PLUG

Product Code: SP-GAZC-01

- TSE K412 Certified
- It is an insulation panel connector
- Provides fast and easy installation in aerated concrete applications, thanks to its TSE K412 Certified special design
- Edgy tearing design shows maximum holding resistance
- It has a sturdy head design, which is resistant to adze impact
- The product design was developed by STAR PLASTİK A.Ş.

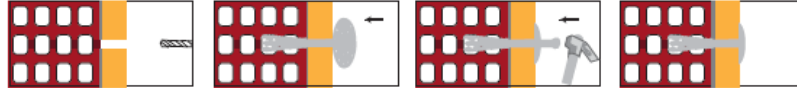

Drill Diameter
Aerated concrete
10 mm



Product Code	Colour	Wall Plug Cap Diameter (mm)	Wall Plug Body Diameter (mm)	Wall Plug Length (mm)	Nail Type	In-Package Quantity
SP-YAGD-01-11-01	Blue	60	10	110	Plastic	500
SP-YAGD-01-14-01	Blue	60	10	140	Plastic	500

PLASTIC NAIL WALL PLUG

Basic Material

- Aerated concrete

Application Surface

- Rock Wool
- Glass Wool
- EPS
- XPS Panels
- Aerated concrete panels



GAS FUSED WALL PLUG

Product Code: SP-GAZC-01-03-01

- It is designed to be used in rock wool installation to curtain wall, insulation panel connections of garage ceiling and balcony floor where is hard to work.
- Suitable for concrete surfaces
- Fast application with gun
- Easy-to-install
- Maximum holding
- Stainless nail with dip galvanized coating



Product Code	Colour	Wall Plug Cap Diameter (mm)	Wall Plug Length (mm)	Nail Type	In-Package Quantity
SP-GAZC-01-03-01	Blue	60	30	Steel	1.000
SP-GAZC-01-04-01	Blue	60	40	Steel	1.000
SP-GAZC-01-05-01	Blue	60	50	Steel	1.000
SP-GAZC-01-06-01	Blue	60	60	Steel	1.000
SP-GAZC-01-07-01	Blue	60	70	Steel	1.000
SP-GAZC-01-08-01	Blue	60	80	Steel	1.000
SP-GAZC-01-09-01	Blue	60	90	Steel	1.000

GALVANIZED NAIL



Gas Fused Gun and Fuel Cell

Basic Material

- Concrete

Application Surface

- Applications
- Balcony Floors
- Garage Ceilings



GLASS WOOL AND ROCK WOOL WALL PLUG USED IN CURTAIN WALL

Product Code: SP-GCID-01

- Easy installation without nail
- It is used in the mounting to the facade of rock wool panels whose density is low and which has a sufficient insulating value
- It prevents the panel from being crushed and changing insulation property thanks to its locking zone
- Can be used in all wall forms
- Safe load distribution



Drill Diameter

On hollow surfaces
7 mm

On solid surfaces
8 mm



Product Code	Colour	Measurement	Nail Type	In-Package Quantity
SP-GCID-01-05-01	White	5 cm for Rock Wool	Nailless	500
SP-GCID-01-08-01	White	8 cm for Rock Wool	Nailless	500

PLASTIC WALL PLUG

Basic Material

- Concrete
- Solid Brick
- Hollow Brick
- Bims
- Aerated Concrete

Application Surface

- Rock Wool
- Glass Wool



LOCKING UNDER CURTAIN WALL ROCK WOOL WALL PLUG

Product Code: SP-LEVC-01

- It is used in the mounting to the facade of rock wool panels whose density is low and which has a sufficient insulating value
- It prevents the panel from being crushed and changing insulation property value thanks to its locking zone
- Can be used in all wall forms
- It has a sturdy head design, which is resistant to adze impact
- Safe load distribution
- The details on its head increase plaster retention
- The product design was developed by STAR PLASTİK A.Ş.

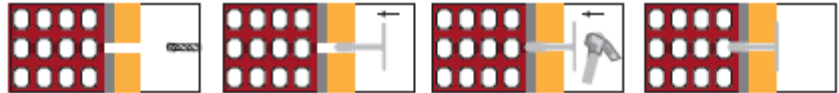

Drill Diameter

On hollow surfaces
10 mm
On solid surfaces
11 mm



Product Code	Panel Thickness (cm)	Wall Plug Cap Diameter (mm)	Wall Plug Body Diameter (mm)	Wall Plug Length (mm)	Nail Type	In-Package Quantity
SP-LEVC-01-04-01	4	60	10	100	Steel	500
SP-LEVC-01-05-01	5	60	10	100	Steel	500
SP-LEVC-01-06-01	6	60	10	120	Steel	500
SP-LEVC-01-08-01	8	60	10	120	Steel	500
SP-LEVC-01-10-01	10	60	10	160	Steel	500

STEEL NAIL WALL PLUG (Green)

Product Code	Panel Thickness (cm)	Wall Plug Cap Diameter (mm)	Wall Plug Body Diameter (mm)	Wall Plug Length (mm)	Nail Type	In-Package Quantity
SP-LEVS-01-04-01	4	60	10	100	Plastic	500
SP-LEVS-01-05-01	5	60	10	100	Plastic	500
SP-LEVS-01-06-01	6	60	10	120	Plastic	500
SP-LEVS-01-08-01	8	60	10	120	Plastic	500
SP-LEVS-01-10-01	10	60	10	160	Plastic	500

PLASTIC NAIL WALL PLUG (Black)

Product Code	Panel Thickness (cm)	Wall Plug Cap Diameter (mm)	Wall Plug Body Diameter (mm)	Wall Plug Length (mm)	Nail Type	In-Package Quantity
SP-LEVS-02-04-01	4	60	10	100	Plastic	500
SP-LEVS-02-05-01	5	60	10	100	Plastic	500
SP-LEVS-02-06-01	6	60	10	120	Plastic	500
SP-LEVS-02-08-01	8	60	10	120	Plastic	500
SP-LEVS-02-10-01	10	60	10	160	Plastic	500

PLASTIC NAIL WALL PLUG (Green)

Basic Material

- Concrete
- Solid Brick
- Hollow Brick
- Bims
- Aerated Concrete

Application Surface

- Rock Wool
- Glass Wool



METAL WALL PLUG

Product Code: SP-MTLD-01

- Complying with the New Fire Code
- A1 class fire endurance with metal structure
- High mechanical endurance
- High holding
- Fast installation with hammer
- Installation without a hole in aerated concrete



Drill Diameter

On hollow surfaces
10 mm
On solid surfaces
11 mm



Product Code	Material Description	Wall Plug Cap Diameter (mm)	Wall Plug Body Diameter (mm)	Wall Plug Length (mm)	In-Package Quantity
SP-MTLD-01-11	Metal-	40	8	110	500
SP-MTLD-01-14	Metal-	40	8	140	500
SP-MTLD-01-17	Metal-	40	8	170	500
SP-MTLD-01-19	Metal-Headed	40	8	190	500

METAL WALL PLUG

Product Code	Material Description	Wall Plug Cap Diameter (mm)	Wall Plug Body Diameter (mm)	Wall Plug Length (mm)	In-Package Quantity
SP-MTLDB-01-11	Plastic Head	90	8	110	500
SP-MTLDB-01-14	Plastic Head	90	8	140	500
SP-MTLDB-01-17	Plastic Head	90	8	170	500
SP-MTLDB-01-19	Plastic Head	90	8	190	500

PLASTIC-HEADED METAL WALL PLUG

Product Code	Measurement (mm)	In-Package Quantity
SP-MPUL-01-01	Size 90	500

METAL WASHER

Basic Material

- Concrete
- Solid Brick
- Hollow Brick
- Bims
- Aerated Concrete

Application Surface

- Rock Wool
- Glass Wool
- Aerated Concrete Panel



OSB AND EXTERIOR FACING WALL PLATE WALL PLUG

Product Code: SP-OSB-OI

- Suitable for all insulation panels
- Can be used in siding applications like OSB, gypsum board, precast concrete
- With metal or wood profile holders, it is suitable for coating application to prefabricated walls or front walls.
- Easy-to-install
- During the application; self-drilling screws should be used for the profiles like iron, metal; and drywall screw should be used only if it will stay on the panel.
- In case of the use of drywall screw, a screw which is maximum 1 cm longer than the insulation thickness should be preferred and installed at low speed
- The details on its head increase plaster retention
- The product design was developed by STAR PLASTİK A.Ş.

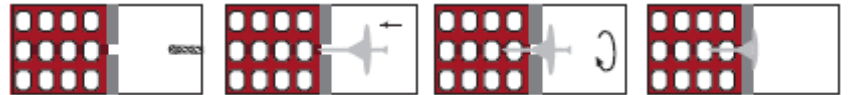

Product Code	Colour	Wall Plug Cap Diameter (mm)	Wall Plug Body Diameter (mm)	Wall Plug Length (mm)	Nail Type	In-Package Quantity
SP-OSB-01	Red	60	25		Screwless	1.000

SCREWLESS

Product Code	Colour	Wall Plug Cap Diameter (mm)	Wall Plug Body Diameter (mm)	Wall Plug Length (mm)	Nail Type	In-Package Quantity
SP-OSBV-01-04-01	Red	60	25	40	With screw	1.000
SP-OSBV-01-05-01	Red	60	25	50	With screw	1.000
SP-OSBV-01-06-01	Red	60	25	60	With screw	1.000
SP-OSBV-01-07-01	Red	60	25	70	With screw	1.000
SP-OSBV-01-08-01	Red	60	25	80	With screw	1.000
SP-OSBV-01-09-01	Red	60	25	90	With screw	1.000
SP-OSBV-01-10-01	Red	60	25	100	With screw	1.000

WITH SCREW

Basic Material

- Gypsum Board
- Particle board
- Plywood
- Metal

Application Surface

- Rock Wool
- Glass Wool
- EPS Panel
- XPS Panel

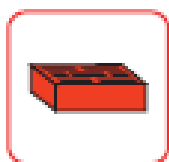
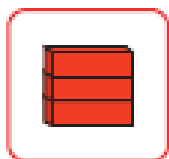
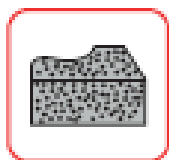

Drill Diameter
8 mm



STAR NAILLESS CONCRETE WALL PLUG TOOTHED

Product Code: SP-STRB-01

- The optimised geometry of the expansion area provides low depth of embedment and therefore reduces necessary amount of drilling.
- Flexible bolts on the board are compatible with the insulation material, providing a constant contact pressure.
- The easy hammer tool makes it possible for a fast assembly process and therefore reduces the workload.
- Can be used in the floor heating panel applications



Product Code	Colour	Wall Plug Cap Diameter (mm)	Wall Plug Body Diameter (mm)	Wall Plug Length (mm)	Nail Type	In-Package Quantity
SP-STRB-01-05-01	Black	35	8	50	Nailless	1.000
SP-STRB-01-07-01	Black	35	8	70	Nailless	1.000
SP-STRB-01-09-01	Black	35	8	90	Nailless	1.000
SP-STRB-01-11-01	Black	35	8	110	Nailless	1.000
SP-STRB-01-13-01	Black	35	8	130	Nailless	1.000
SP-STRB-01-15-01	Black	35	8	150	Nailless	1.000
SP-STRB-01-17-01	Black	35	8	170	Nailless	1.000
SP-STRB-01-19-01	Black	35	8	190	Nailless	1.000

PLASTIC WALL PLUG

Product Code	Colour	Wall Plug Cap Diameter (mm)	Wall Plug Body Diameter (mm)	Wall Plug Length (mm)	Nail Type	In-Package Quantity
SP-STRB-01-05-02	Yellow	35	8	50	Nailless	1.000
SP-STRB-01-07-02	Yellow	35	8	70	Nailless	1.000
SP-STRB-01-09-02	Yellow	35	8	90	Nailless	1.000
SP-STRB-01-11-02	Yellow	35	8	110	Nailless	1.000
SP-STRB-01-13-02	Yellow	35	8	130	Nailless	1.000
SP-STRB-01-15-02	Yellow	35	8	150	Nailless	1.000
SP-STRB-01-17-02	Yellow	35	8	170	Nailless	1.000
SP-STRB-01-19-02	Yellow	35	8	190	Nailless	1.000

PLASTIC WALL PLUG

Basic Material

- Concrete
- Solid Brick
- Hollow Brick
- Bims
- Aerated Concrete

Application Surface

- Rock Wool
- Glass Wool
- EPS Panel
- XPS Panel

“

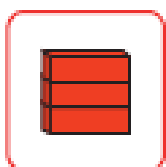
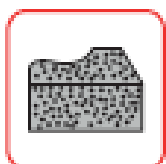

STAR NAILLESS CONCRETE WALL PLUG

Product Code: SP-STRB-01-05-01

- The optimised geometry of the expansion area provides low depth of embedment and therefore reduces necessary amount of drilling.
- Flexible bolts on the board are compatible with the insulation material, providing a constant contact pressure.
- The easy hammer tool makes it possible for a fast assembly process and therefore reduces the workload.
- Can be used in the floor heating panel applications



Drill Diameter
8 mm



Product Code	Colour	Wall Plug Cap Diameter (mm)	Wall Plug Body Diameter (mm)	Wall Plug Length (mm)	Nail Type	In-Package Quantity
SP-STRB-01-08-01	Transparent	45	8	80	Nailless	1.000
SP-STRB-01-10-01	Transparent	45	8	100	Nailless	1.000

PLASTIC WALL PLUG

Basic Material

- Concrete
- Solid Brick

Application Surface

- Rock Wool
- Glass Wool
- EPS Panel
- XPS Panel

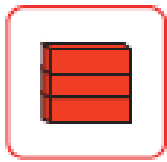
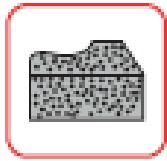

SHORE PRESSURE JAMB WALL PLUG

Product Code: SP-TBSÖ-01

- TSE K412 Certified
- Specially designed for fiber cement siding installations
- Establishes mechanical connection of the installation
- Can be used in all wall forms
- Safe load distribution



Product Code	Colour	Wall Plug Cap Diameter (mm)	Wall Plug Body Diameter (mm)	Wall Plug Length (mm)	Nail Type	In-Package Quantity
SP-TBSO-01-10-01	Red	60	10	100	Plastic	500
SP-TBSO-01-12-01	Red	60	10	120	Plastic	500
SP-TBSO-01-16-01	Red	60	10	160	Plastic	500

PLASTIC NAIL WALL PLUG

Basic Material

- Concrete
- Solid Brick
- Hollow Brick
- Bims
- Aerated Concrete

Application Surface

- Fiber Cement Panel
- Specially Coated Panel



EPS HARD FOAM SHEET NAIL

Product Code: SP-HPOR-OI

- It is used in prefabricated concrete constructions and underfloor insulation
- The bulges of the nails submerged in the pre-prepared materials like heraklith, polystyrene etc. stay inside of the concrete and therefore be fixed by the concrete



Product Code	Colour	Wall Plug Cap Diameter (mm)	Wall Plug Body Diameter (mm)	Wall Plug Length (mm)	Nail Type	In-Package Quantity
SP-HPOR-01	Black	35	100	45	NAILLESS	2.000

NAILLESS

Basic Material

- Concrete

Application Surface

- Heraklith
- Polystyrene etc. Applications



DRAINAGE PLATE PIN

Product Code: SP-HPOR-OI

- The drainage plate bolt is a product designed to be used in the mounting of the plate (drainage plate) that ensures that the drainage is done soundly while the waterproofing materials used in the base isolation applications are being locked in and after.
- The side of the material adhered to the insulation is prepared with a special tape (bitumen).
- Thanks to this, the material easily adheres to the bitumen membrane or XPS material and does not come off again.
- Protective materials are easily mounted by sticking the product to the notched and pointed bearing zone.
- The drainage bolt attached to the waterproofing must be plastic, metal is not used.
- While the base is filled, the load mounted leads to the puncturing of the insulation material of the metal material.
- After all the application is finished, the application would have been done for nothing due to these holes. The surface receives water from these regions.



Product Code	Nail Type	Wall Plug Length (mm)	In-Package Quantity
SP-DJLP-01-06-01	Bitumen Banded	60	500
SP-DJLP-01-08-01	Bitumen Banded	80	500



SUB-BASEMENT BLOCK GAGE

Product Code: SP-SBAT-01-03-01

- The sub-basement profiles, which are referred to as the initial profiles of the heat insulation system in the buildings, are designed in various thicknesses by taking wall skewnesses into consideration for the proper connection.



Product Code	Colour	Wall Plug Body Diameter (mm)	In-Package Quantity
SP-SBAT-01-03-01	Red	3	100
SP-SBAT-01-05-01	Red	5	100
SP-SBAT-01-08-01	Red	8	100
SP-SBAT-01-10-01	Red	10	100

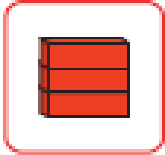

Drill Diameter
On hollow surfaces
8 mm
On solid surfaces
9 mm



SPIN WALL PLUG

Product Code: SP-SPIN-01

- New special design
- It provides 100% solution for the insulation applications
- It is mounted into the insulation panel thanks to its special design
- Mechanical nails provide maximum adhesion
- It reduces the plastering cost
- Suitable for all wall forms
- The product design was developed by STAR PLASTİK A.Ş.

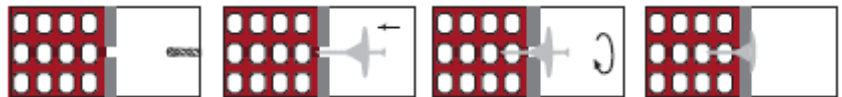

Product Code	Colour	Wall Plug Cap Diameter (mm)	Wall Plug Body Diameter (mm)	Wall Plug Length (mm)	Nail Type	In-Package Quantity
SP-SPIN-01-12-01	Red	60	8	115	Screw	500
SP-SPIN-01-14-01	Red	60	8	135	Screw	500
SP-SPIN-01-16-01	Red	60	8	155	Screw	500

WITH SCREW

Basic Material

- Concrete
- Solid Brick
- Hollow Brick
- Bims
- Aerated Concrete

Application Surface

- Rock Wool
- EPS

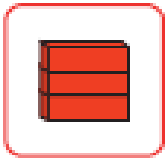

COUNTERSINK APPARATUS

Product Code: SP-HAVS-01

- When the fasteners (Wall plugs) used in external heat insulation applications are applied, the hole is opened to the face and the wall plug is placed into this hole and the application is completed with the nail being driven in.
- At the end of the application, the parachute-headed heat insulation wall plug forms a thickness of 2 mm on EPS and XPS. To prevent this thickness, applications ensure that the application of a countersink with a defined minimum 3 mm to 4 mm on the EPS or XPS is secure in plaster consumption.
- In places where the countersink is not opened, the wall plug is struck by a hammer many times, and the connection element is damaged and the plaster consumption increases over what was calculated by the formation of skewness in the plates, plus the labor costs increase.
- In consideration of this situation, the drill bits used are mounted by being pushed from the rear of each thanks to the easy design done for the countersink apparatus produced.
- Thanks to the ease of use of the price economy, it ensures that the existing quantities of all of the teams are able to be used as a team together with the countersink apparatus. During the completion of the hole work in the drilling application, the countersink is opened in its position.

Product Code	Colour	Product Diameter (mm)	Body Diameter (mm)	Product Length (mm)	In-Package Quantity
SP-HAVS-01	Yellow	60	10	160-300 mm	10 Pcs



SP STAR HELMET

Product Code: SP-BART-01

- It is used as a precaution against accidents that may occur in construction sites and mines.
- The interior design has a shock absorbing feature.
- It is produced from high density polyethylene



Product Code	Colour	In-Package Quantity
SP-BART-01-01	RED	40
SP-BART-01-02	WHITE	40
SP-BART-01-03	ORANGE	40
SP-BART-01-04	BLUE	40
SP-BART-01-05	GREEN	40
SP-BART-01-06	YELLOW	40
SP-BART-01-07	BLACK	40

ADJUSTABLE
HELMET

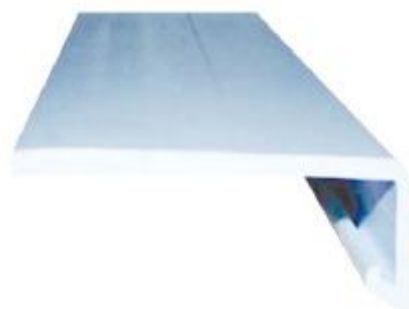

SILL EXTENSION PROFILE

Product Code: SP-BART-01

- In the repair buildings, the insulated used at the end of the facade jacketing applications can come over the marble in the glass faces. In this case, the insulation is useful for sill and drip extension without spoiling the marble due to its protective feature.

Product Code	Measurement (mm)	In-Package Quantity
SP-DUZP-01-05	5	30 mt
SP-BART-01-08	8	30 mt



PVC NETTED CORNER PROFILE

Product Code: SP-PVCK-02

- It must be resistant to alkaline environment and to corrosion.
- It must be an L profile at a wall thickness of 1.5-2 mm of dimensions of at least "x" sizes from glass-fibre mesh (impregnated) or fibreglass material with plastic or fibreglass pregnated upon.
- As they will act as a fitter in liquid application, its surfaces must be blemish-free, at its corner bracket, and smooth.
- The PVC netted angular corner profile is applied in structures at angles of 0-180°, in inside or outside corners, and after the bonding and fixing of the heat insulation plates.
- The first coat is attached to the plaster with a steel trowel and the second coat is finished with plastering in order to ensure solid, smooth, and sharp lines.
- Thanks to its production as a net, it creates a strong adherence between the first and second floor plaster and ensures the plaster integrity.
- The most important feature of the profile is that it can be easily used in angled corners ranging from 0-180°.

Product Code	Product	Colour	Measurement (mm)	In-Package Quantity
SP-PVCTY-02-01	With net	White	25X2,5 MT	62,5 MT

Product Code	Product	Colour	Measurement (mm)	In-Package Quantity
SP-PVCK-02-01	With net	White	25X2,5 MT	62,5 MT
SP-PVCK-02-02	With net	Orange	25X2,5 MT	62,5 MT
SP-PVCK-02-03	With net	Blue	25X2,5 MT	62,5 MT



PLASTER MESH

Product Code: SP-SFILE-01

- Plaster meshes are reinforcement meshes woven from glass yarn. With a special coating, it is made resistant to external weather conditions and alkalinity
- The flexibility of plaster mesh must not exceed 4% in both directions. As the coating thickness increases, the resistance of the material to external factors and alkalinity also increases
- The width is at least 25-30 cm when it is used in construction materials. It is used in the reinforcing of epoxy flooring in the joints.
- It is used in the reinforcing of cement-based plastic-tempered liquid waterproofing materials, in plaster done on gypsum board and aerated concrete at a minimum width of 25-30 cm, and in places where different materials meet in external heat insulation systems.



Product Code	Measurement	Colour	In-Package Quantity (MT)
SP-SFILE-01-01	4X4160 gr/m ²	WHITE	50
SP-SFILE-01-02	4X4160gr/m ²	BLUE	50
SP-SFILE-01-03	4X4160gr/m ²	RED	50



HEAVY LOAD WALL PLUG

Product Code: SP-AYD-01-12-01

- Special double opening tearing design
- Easy-to-install
- Special body structure with 6 notches,
- Wings open when the screw is tightened
- It has high load capacity for aerated concrete, exposed concrete, hollow brick, solid brick and bims surfaces
- Safe carriage in air conditioner, radiator, sink etc. connections
- Suitable for different applications varying from curtain wall anchoring to woodworking montage
- The product design was developed by STAR PLASTİK A.Ş.

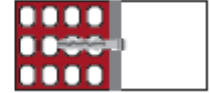
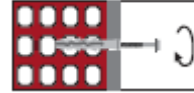
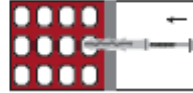

Product Code	Colour	Screw Diameter (mm)	Wall Plug Body Diameter (mm)	Wall Plug Length (mm)	Nail Type	In-Package Quantity
SP-AYD-01-08-01	Navy Blue		10	80	Screwless	1000
SP-AYD-01-10-01	Navy Blue		10	100	Screwless	1000
SP-AYD-01-12-01	Navy Blue		10	120	Screwless	1000
SP-AYD-01-14-01	Navy Blue		10	140	Screwless	1000
SP-AYD-01-16-01	Navy Blue		10	160	Screwless	1000

SCREWLESS

Product Code	Colour	Screw Diameter (mm)	Wall Plug Body Diameter (mm)	Wall Plug Length (mm)	Nail Type	In-Package Quantity
SP-AYDV-01-08-01	Navy Blue	7	10	80	With screw	100
SP-AYDV-01-10-01	Navy Blue	7	10	100	With screw	100
SP-AYDV-01-12-01	Navy Blue	7	10	120	With screw	100
SP-AYDV-01-14-01	Navy Blue	7	10	140	With screw	100
SP-AYDV-01-16-01	Navy Blue	7	10	160	With screw	50

WITH SCREW

Basic Material

- A, B, C, D, E Classes
- Concrete
- Solid Brick
- Hollow Brick
- Bims
- Aerated Concrete

Application Surface

- Electrical Wiring
- Mechanical Wiring
- Dropped Floor
- Support Systems
- Shelves
- Curtains
- Lamps



HOLLOW BRICK WALL PLUG

Product Code: SP-BTD-01-10-01

- Special double opening tearing design
- Easy-to-install
- Special body structure with 6 notches,
- Wings open when the screw is tightened
- Safe holding on wide surface thanks to long tearing
- Can be used in fixing window frames and door frames, sub-basement profile fixing and jamb applications thanks to its special tooth design
- The product design was developed by STAR PLASTİK A.Ş.

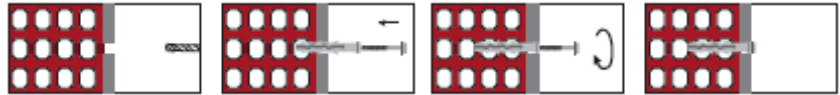

Product Code	Colour	Screw Diameter (mm)	Wall Plug Body Diameter (mm)	Wall Plug Length (mm)	Nail Type	In-Package Quantity
SP-BTD-01-06-01	Navy Blue		8	60	Screwless	1000
SP-BTD-01-08-01	Navy Blue		8	80	Screwless	1000
SP-BTD-01-10-01	Navy Blue		8	100	Screwless	1000

SCREWLESS

Product Code	Colour	Screw Diameter (mm)	Wall Plug Body Diameter (mm)	Wall Plug Length (mm)	Nail Type	In-Package Quantity
SP-BTDV-01-06-01	Navy Blue	5-6	8	60	With screw	100
SP-BTDV-01-08-01	Navy Blue	5-6	8	80	With screw	100
SP-BTDV-01-10-01	Navy Blue	5-6	8	100	With screw	100

WITH SCREW

Basic Material

- A, B, C, D, E Classes
- Concrete
- Solid Brick
- Hollow Brick
- Bims
- Aerated Concrete

Application Surface

- Electrical Wiring
- Mechanical Wiring
- Dropped Floor
- Support Systems
- Shelves
- Curtains
- Lamps



PANEL WALL PLUG

Product Code: SP-PNLD-02-08-01

- Designed for mounting medium duty loads onto gypsum boards and similar panels
- Easy-to-install
- Provides squeezing from back and front surfaces without causing a deformation in the material body
- Has high stability and breaking strength
- It can be used on aerated surfaces such as hollow brick
- During screw montage, body pulls itself and provides a safe holding

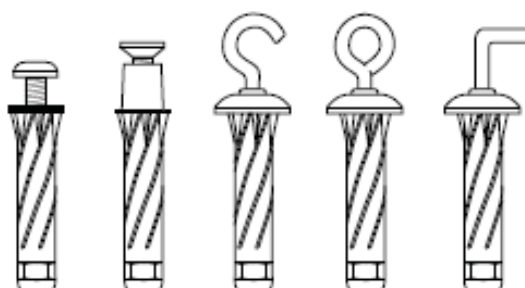
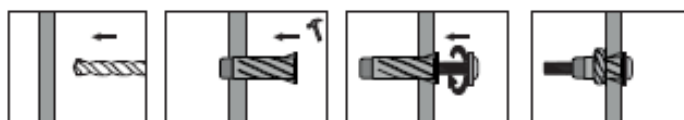

Product Code	Colour	Screw Diameter (mm)	Wall Plug Body Diameter (mm)	Wall Plug Length (mm)	Nail Type	In-Package Quantity
SP-PNLD-02-08-01	Colourful		8	50	Screwless	1200

SCREWLESS

Product Code	Colour	Screw Diameter (mm)	Wall Plug Body Diameter (mm)	Wall Plug Length (mm)	Nail Type	In-Package Quantity
SP-PNLDV-02-08-01	Colourful	5	8	50	With screw	100

WITH SCREW

- Basic Material**
- Gypsum Board
 - Particle board
 - Plywood
 - Cavity Wall and Ceiling

- Application Surface**
- Wall Protection Strip
 - Shelves
 - Hangers
 - Curtain



ALL-ROUND WALL PLUG

Product Code: SP-ALLR-01-04-01

- It was designed with two expandable wings for maximum hold
- Suitable for all surfaces
- Superior holding force
- Easy-to-install
- It provides safe holding by applying extra pressure to lateral surfaces thanks to its special design
- Wing design holds anchor in place by preventing the rotation during screw montage

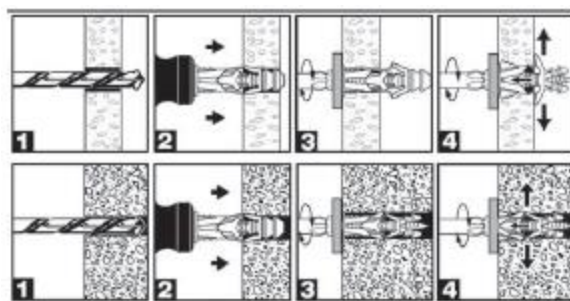

Product Code	Colour	Screw Diameter (mm)	Wall Plug Body Diameter (mm)	Wall Plug Length (mm)	Nail Type	In-Package Quantity
SP-ALLR-01-04-01	Black		8	40	Screwless	1000
SP-ALLR-01-04-02	Colourful		8	40	Screwless	1000

SCREWLESS

Product Code	Colour	Screw Diameter (mm)	Wall Plug Body Diameter (mm)	Wall Plug Length (mm)	Nail Type	In-Package Quantity
SP-ALLV-01-04-01	Black	5	8	40	With screw	100
SP-ALLV-01-04-02	Colourful	5	8	40	With screw	100

WITH SCREW

Basic Material

- A, B, C, D, E Classes
- Concrete
- Solid Brick
- Hollow Brick
- Bims
- Aerated Concrete
- Gypsum Board

Application Surface

- Electrical Wiring
- Mechanical Wiring
- Dropped Floor
- Support Systems
- Shelves
- Curtains
- Lamps



STANDARD WALL PLUG

Product Code: SP-STAN-01-03-01

- Special winged design
- High holding strength
- Easy and safe montage



Product Code	Colour	Screw Diameter (mm)	Wall Plug Body Diameter (mm)	Wall Plug Length (mm)	Nail Type	In-Package Quantity
SP-STAN-01-03-01	Navy Blue		6	30	Screwless	1000
SP-STAN-01-04-01	Navy Blue		8	40	Screwless	1000
SP-STAN-01-05-01	Navy Blue		10	50	Screwless	1000
SP-STAN-01-06-01	Navy Blue		12	55	Screwless	1000

SCREWLESS

Product Code	Colour	Screw Diameter (mm)	Wall Plug Body Diameter (mm)	Wall Plug Length (mm)	Nail Type	In-Package Quantity
SP-STANV-01-03-01	Navy Blue	4,5-5	6	30	With screw	100
SP-STANV-01-04-01	Navy Blue	5	8	40	With screw	100
SP-STANV-01-05-01	Navy Blue	6	10	50	With screw	100
SP-STANV-01-06-01	Navy Blue	7	12	55	With screw	100

WITH SCREW

Basic Material

- A, B, C, D, E Classes
- Concrete
- Solid Brick
- Hollow Brick
- Bims
- Aerated Concrete

Application Surface

- Electrical Wiring
- Mechanical Wiring
- Dropped Floor
- Support Systems
- Shelves
- Curtains
- Lamps



INDOOR AERATED CONCRETE WALL PLUG

Product Code: SP-BIGB-01-10-01

- Produced for aerated concrete
- Produced for aerated concrete
- Thanks to its spiral-shaped, inverted structure, it achieves a high conveyance by making suitable pressure distribution
- It has the property of holding the twice the hole diameter
- It does not crack or break while driven in

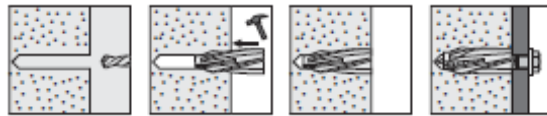

Product Code	Colour	Steel Diameter (mm)	Screw Diameter (mm)	Wall Plug Length (mm)	Nail Type	In-Package Quantity
SP-BIGB-01-08-01	Transparent	8		50	Screwless	250
SP-BIGB-01-10-01	Transparent	10		53	Screwless	250

SCREWLESS

Product Code	Colour	Steel Diameter (mm)	Screw Diameter (mm)	Wall Plug Length (mm)	Nail Type	In-Package Quantity
SP-BIGBV-01-08-01	Transparent	8	6	50	With screw	100
SP-BIGBV-01-10-01	Transparent	10	7	53	With screw	100

WITH SCREW

Basic Material

- Aerated Concrete

Application Surface

- Electrical Wiring
- Mechanical Wiring
- Dropped Floor
- Support Systems
- Shelves
- Curtains
- Lamps

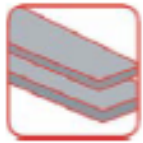

TURBOLET GYPSUM BOARD WALL PLUG

Product Code: SP-TAD-02-01

- Can be used on gypsum boards and similar surfaces
- Easy-to-install
- Body structure of the material provides a mechanical junction

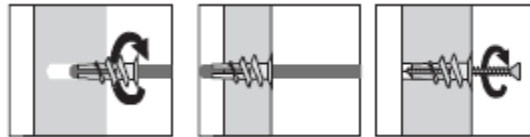

Product Code	Colour	Body Type	Screw Diameter (mm)	Wall Plug Length (mm)	Nail Type	In-Package Quantity
SP-TAD-02-01	Transparent	Plastic		30	Screwless	1000

SCREWLESS

Product Code	Colour	Body Type	Screw Diameter (mm)	Wall Plug Length (mm)	Nail Type	In-Package Quantity
SP-TADV-02-01	Transparent	Plastic	4,5-5	30	With screw	100

WITH SCREW

Basic Material

- Gypsum Board

Application Surface

- Lamps
- Bathroom Accesories
- Wireways
- Curtains
- Shelves

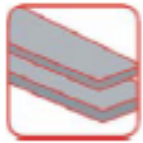

GYPSUM BOARD WINGED WALL PLUG

Product Code: SP-KALD-01-02-01

- Designed to be used in gypsum boards, woods and similar wall mountings
- Provides safe connection on the application surface via its special wing structure
- Easy-to-install
- While inserting the screw, body pulls itself to open the wings

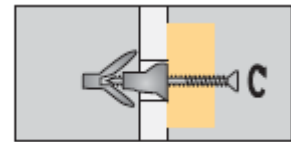
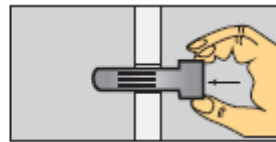
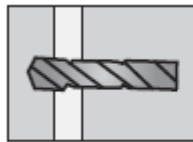

Product Code	Colour	Wall Plug Cap Diameter (mm)	Drill Diameter (mm)	Wall Plug Length (mm)	Screw Diameter (mm)	In-Package Quantity
SP-KALD-01-02-01	Transparent	10	10	35		5000
SP-KALD-01-03-01	Transparent	10	10	40		5000

SCREWLESS

Product Code	Colour	Wall Plug Cap Diameter (mm)	Drill Diameter (mm)	Wall Plug Length (mm)	Screw Diameter (mm)	In-Package Quantity
SP-KALDV-01-02-01	Transparent	10	10	35	5	100
SP-KALDV-01-03-01	Transparent	10	10	40	5	100

WITH SCREW

Basic Material

- Gypsum Board

Application Surface

- Lamps
- Bathroom Accesories
- Wireways
- Curtains
- Shelves



BRICK CAVITY WALL PLUG

Product Code: SP-TBD-01

- High holding thanks to the wings opening to 4 different sides
- High quality nylon structure
- Flexible Structure
- Top wings preventing rotation



Drill Diameter

On hollow surfaces
10 mm

On solid surfaces
11 mm



Product Code	Colour	Screw Diameter (mm)	Wall Plug Body Diameter (mm)	Wall Plug Length (mm)	Nail Type	In-Package Quantity
SP-TBD-01-04-01	Grey	5-6	8	40	Screwless	1000
SP-TBD-01-05-01	Grey	6-7	10	50	Screwless	1000
SP-TBD-01-07-01	Grey	7-8	12	70	Screwless	1000

SCREWLESS

Product Code	Colour	Screw Diameter (mm)	Wall Plug Body Diameter (mm)	Wall Plug Length (mm)	Nail Type	In-Package Quantity
SP-TBDV-01-04-01	Grey	5-6	8	40	With screw	1000
SP-TBDV-01-05-01	Grey	6-7	10	50	With screw	1000
SP-TBDV-01-07-01	Grey	7-8	12	70	With screw	1000

WITH SCREW

Basic Material

- Concrete
- Natural Stone
- Hollow Brick
- Solid Brick
- Bims
- Asphalt
- Gypsum Board
- Aerated Concrete

Application Surface

- Furniture
- Shelf
- Figure
- Lamp
- Electrical Equipment
- Bathroom Accesory
- All Kinds of Light Load Mounting



ROCKET WALL PLUG

Product Code: SP-RKT-01

- Flexible Structure
- Top wings preventing rotation
- Excellent fixing



Drill Diameter

On hollow surfaces

10 mm

On solid surfaces

11 mm



Product Code	Colour	Screw Diameter (mm)	Wall Plug Body Diameter (mm)	Wall Plug Length (mm)	In-Package Quantity
SP-RKT-01-05-01	Yellow		8	50	1000
SP-RKT-01-06-01	Yellow		10	60	1000

Product Code	Colour	Screw Diameter (mm)	Wall Plug Body Diameter (mm)	Wall Plug Length (mm)	In-Package Quantity
SP-RKTV-01-05-01	Yellow	5-6	8	50	1000
SP-RKTV-01-06-01	Yellow	6-7	10	60	1000

SCREWLESS

WITH SCREW

Basic Material

- Concrete
- Natural Stone
- Hollow Brick
- Solid Brick
- Bims
- Asphalt
- Gypsum Board
- Aerated Concrete

Application Surface

- Furniture
- Shelf
- Figure
- Lamp
- Electrical Equipment
- Bathroom Accessory
- All Kinds of Light Load Mounting



www.spstarplast.net



**STAR PLASTİK YAPI ELEMANLARI
İZOLASYON MALZEMELERİ SAN. TİC. A.Ş.**

Ortaköy Merkez Mahallesi Dumlupınar Caddesi
No:44 P.K 34582 Ortaköy / Silivri
İSTANBUL/TURKEY
T : 0212 744 82 60 Pbx
F : 0212 744 82 92
Factory Mobile: 0533 665 85 22

www.spstarplast.net
info@spstarplast.net

www.starodeme.com

